



stanton dahl
architects



DA Issue

This design including its associated drawings, images, etc. is the intellectual property of stanton dahl & associates pty limited and must not be referenced copied or used without written permission of stanton dahl & associates pty limited.

All dimensions to be verified on site and any discrepancies referred to architect for determination. figured dimensions to take precedence over scaled dimensions.

Adventist Aged Care,
Retirement Village
56 Elsom Street,
Kings Langley, NSW

Site Plan - Proposed



Project No;
1522.13

Drawing No; Amendment;
DA03 / 2

Scale; **1:1000 @ A3**

Drawn; lee

Plot date; 19/03/2018

Stanton Dahl Architects

PO Box 833, Epping, NSW 1710

Tel +61 2 8876 5300

www.stantondahl.com.au

Stanton Dahl & Associates Pty Limited, ABN 32 002 261 396 Nominated Architects : D.P Stanton 36 42, F.C Paterson 60 36, D.C Melloh 78 64, S.M Evans 76 86 © Copyright 2016 Stanton Dahl

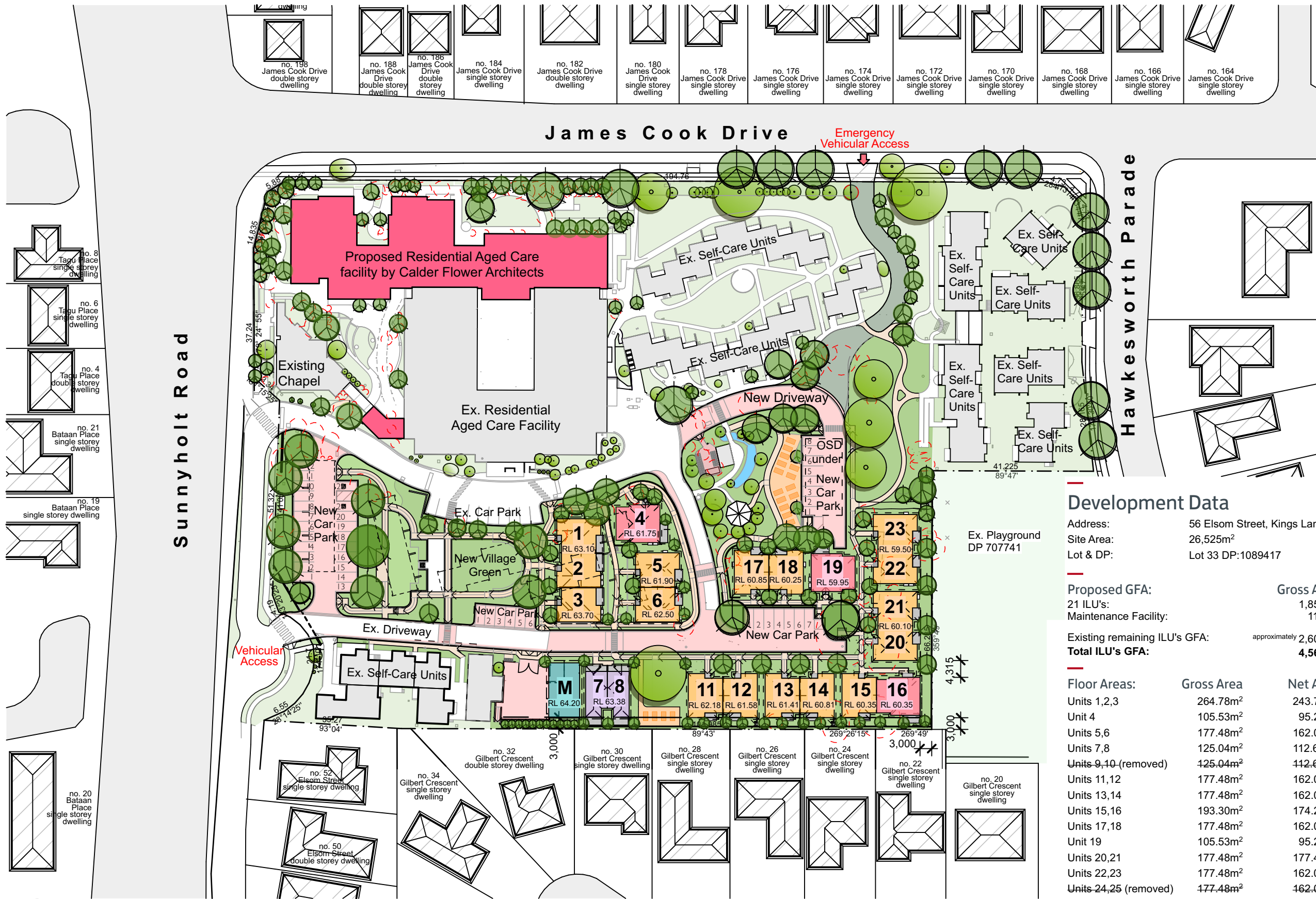

01

Site Plan

1:1000

Legend

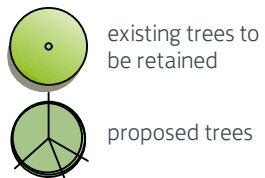

- Maintenance Facility
- 43 New Car Parks
- 1 Bedroom Units = 2 Units
- 2 Bedroom Units = 16 Units
- 3 Bedroom Units = 3 Units

Total ILU's = 21 Units

Development Data

Address: 56 Elsom Street, Kings Langley
Site Area: 26,525m²
Lot & DP: Lot 33 DP:1089417

Proposed GFA: Gross Area
21 ILU's: 1,859m²
Maintenance Facility: 110m²
Existing remaining ILU's GFA: approximately 2,600m²
Total ILU's GFA: 4,569m²

Floor Areas:	Gross Area	Net Area
Units 1,2,3	264.78m ²	243.78m ²
Unit 4	105.53m ²	95.28m ²
Units 5,6	177.48m ²	162.04m ²
Units 7,8	125.04m ²	112.67m ²
Units 9,10 (removed)	125.04m ²	112.67m ²
Units 11,12	177.48m ²	162.04m ²
Units 13,14	177.48m ²	162.04m ²
Units 15,16	193.30m ²	174.21m ²
Units 17,18	177.48m ²	162.04m ²
Unit 19	105.53m ²	95.28m ²
Units 20,21	177.48m ²	177.48m ²
Units 22,23	177.48m ²	162.04m ²
Units 24,25 (removed)	177.48m ²	162.04m ²
Units 26,27 (removed)	177.48m ²	162.04m ²
Total	1,859.06m ²	1,708.90m ²

(Refer to drawings prepared by Calder Flower Architects for Development Data of new RACF building)

Amendment	Date
02 Revised Development Application Issue	19.03.18
01 Development Application Issue	13.01.17



01 Site Plan 1:1000

- Legend
- existing trees to be retained
 - existing trees to be removed
 - existing building to be demolished
 - proposed trees
 - existing building

Stage 1 Development

- Maintenance Facility
- 43 New Car Parks
- 1 Bedroom Units = 4 Units
- 2 Bedroom Units = 9 Units
- 3 Bedroom Units = 2 Units

Stage 1 Total ILU's = 6 Units

Amendment	Date
02 Revised Development Application Issue	19.03.18
01 Development Application Issue	13.01.17

Architecture
Project management
Access consulting
Interior design

stanton dahl
architects



DA Issue

This design including its associated drawings, images, etc. is the intellectual property of stanton dahl & associates Pty limited and must not be referenced copied or used without written permission of stanton dahl & associates Pty limited.

All dimensions to be verified on site and any discrepancies referred to architect for determination. figured dimensions to take precedence over scaled dimensions.

Adventist Aged Care,
Retirement Village
56 Elsom Street,
Kings Langley, NSW

Site Plan - Stage 1

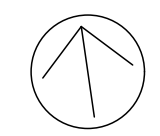

Project No;
1522.13

Drawing No; **DA04** Amendment; **02**

Scale; **1:1000 @ A3**

Drawn; lee

Plot date; 19/03/2018

Stanton Dahl Architects

PO Box 833, Epping, NSW 1710
Tel +61 2 8876 5300

www.stantondahl.com.au

Stanton Dahl & Associates Pty Limited, ABN 32 002 261 396 Nominated Architects : D.P Stanton 3642, F.C Paterson 6036, D.C Melloh 7864, S.M Evans 7686 © Copyright 2016 Stanton Dahl

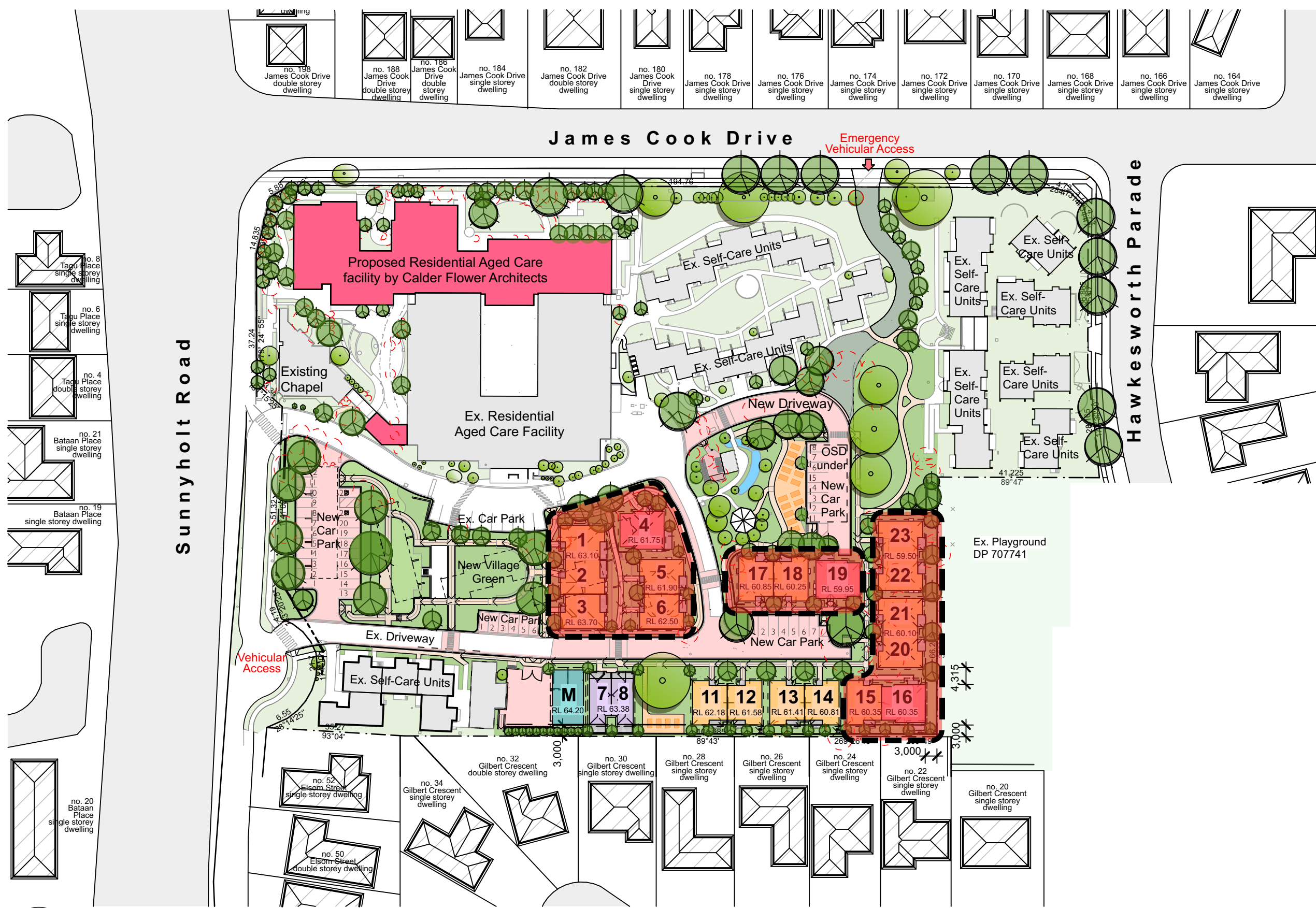

01 Site Plan 1:1000

- Legend**
- existing trees to be retained
 - proposed trees
 - existing trees to be removed
 - existing building
 - existing building to be demolished

Stage 2 Development

- 0 New Car Parks
- 1 Bedroom Units = 0 Units
- 2 Bedroom Units = 6 Units
- 3 Bedroom Units = 0 Units

Stage 2 Total ILU's = 15 Units

Amendment	Date
02 Revised Development Application Issue	19.03.18
01 Development Application Issue	13.01.17

Architecture
Project management
Access consulting
Interior design

stanton dahl
architects



DA Issue

This design including its associated drawings, images, etc. is the intellectual property of stanton dahl & associates pty limited and must not be referenced copied or used without written permission of stanton dahl & associates pty limited.

All dimensions to be verified on site and any discrepancies referred to architect for determination. figured dimensions to take precedence over scaled dimensions.

Adventist Aged Care,
Retirement Village
56 Elsom Street,
Kings Langley, NSW

Site Plan - Stage 2

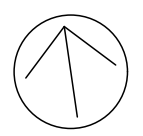

Project No;
1522.13

Drawing No; DA05
Amendment; 02

Scale; 1:1000 @ A3

Drawn; lee

Plot date; 19/03/2018

Stanton Dahl Architects

PO Box 833, Epping, NSW 1710
Tel +61 2 8876 5300

www.stantondahl.com.au

Stanton Dahl & Associates Pty Limited, ABN 32 002 261 396 Nominated Architects : D.P.Stanton 3642, F.C.Paterson 6036, D.C.Mellor 7864, S.M.Evans 7686 © Copyright 2016 Stanton Dahl